

# HE-VA Penta-Tiller

The ideal harrow for false seedbeds and  
weed control in stubble



# The versatile harrow that adapts to the needs and wishes of the farmer...

HE-VA's Penta-Tiller is an ideal harrow for mechanical weed control, and a versatile one at that. The 5-bar harrow has a frame height of 570 mm, which ensures good passage. This prevents residues etc. from sticking.



70x12 mm tines make the Penta-Tiller extremely versatile, with the option of fitting wing shares as standard for full penetration or a standard wear tip for deeper working of the soil. This means that the Penta-Tiller can be supplied with a free choice between the two types of tip, depending on the farmer's needs and wishes.

If the need for the other tip arises, it can be subsequently (or simultaneously) purchased as extra equipment, allowing the farmer to change tips. This gives the farmer two harrows in one.

## Options

Depending on the need, the Penta-Tiller can be supplied with either 180 mm goosefoot points or 52 mm reversible wear tips. In addition, the Penta-Tiller comes with a double-row long-finger after-harrow as standard to ensure smooth passage of stubble residues and optimum mixing of the harrowed material.

### Goosefoot Point, 180 mm

If a full cut is required in an upper tillage operation, HE-VA recommends a 180 mm goosefoot point.



### Reversible Wear Tip, 52 mm

However, if deeper working of the soil is required, a 52 mm reversible wear tip is recommended as standard.

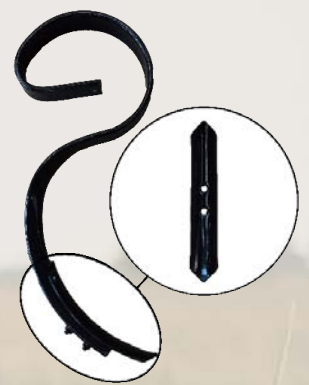



# Extra Equipment

## LED Lights



## Square Tube Roller

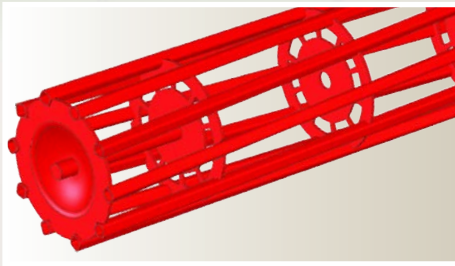

## Flat Bar Roller

Flat iron roller 410 mm, incl. 1 row of Ø12 mm long-finger after-harrow tines.

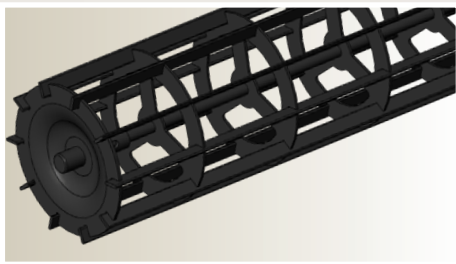

## Extra Set of Tips

Extra set of tine tips can be purchased for the HE-VA Penta-Tiller.

If purchased as standard with reversible wear tips, 180 mm goosefoot points can be purchased as add-ons.

If purchased as standard with goosefoot points, 52 mm reversible wear tips can be purchased as add-ons.



## Top-Cutter

The HE-VA Penta-Tiller can be equipped with a Top-Cutter module with single knife roller.

Mounted between tractor and harrow, the aggressiveness is adjusted manually via spindles.

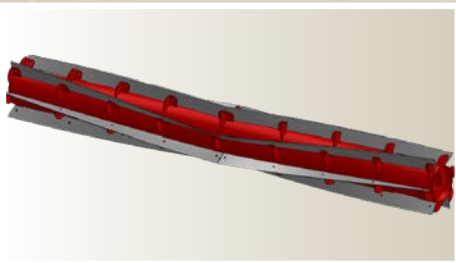

## Spring-Board

The Penta-Tiller can also be equipped with a Spring-Board.

Mounted between tractor and harrow, the aggressiveness is adjusted manually via spindles.

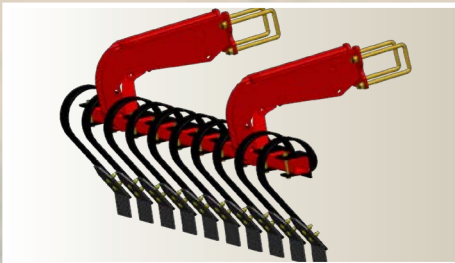

## Mounting Kit for Multi-Seeder

Mounting brackets for the HE-VA Multi-Seeder are available for rape, grass seed and other small seeds, fertiliser or snail poison.





# Technical Specifications



3.00 - 7.00 m



2.48 - 4.00 m

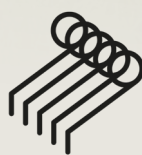

21 - 50 pcs



1,360 - 2,560 kg



70 - 260 hp

Working width, m	Type	Transport width, m	Number of tines	Power requirement, hp	Lifting requirement, kg	Weight, kg
3.00	Rigid	3.00	21	70 - 120	2,450	1,360
3.50	Rigid	3.50	25	80 - 150	2,650	1,470
4.00	Rigid	4.00	29	90 - 180	2,850	1,580
4.00	Hydraulic, 2-joint	2.48	29	90 - 180	4,020	2,230
5.00	Hydraulic, 2-joint	2.48	36	110 - 220	4,220	2,340
6.00	Hydraulic, 2-joint	2.48	43	130 - 240	4,410	2,450
7.00	Hydraulic, 2-joint	2.48	50	150 - 260	4,550	2,560



Tel.: +45 97 72 42 88  
 Fax: +45 97 72 21 12  
 E-mail: [info@he-va.com](mailto:info@he-va.com)  
 Web: [www.he-va.com](http://www.he-va.com)

N.A. Christensensvej 34  
 DK-7900 Nykøbing Mors

Your HE-VA dealer

HE-VA reserves the right to make design and construction changes without notice

