

HE-VA

Disc-Roller Contour



***Precise primary & secondary
cultivation***



Disc-Roller Contour

The ideal multipurpose cultivator

- Precise depth control for stale seedbeds
- Aggressive mintill cultivation
- Levelling and pressing for preparing seedbeds

CONSISTENT CULTIVATION ON UNEVEN GROUND

To make a stale seedbed or prepare a seedbed for drilling, you need to ensure that the machine you are using follows the contours of the field. If not, you will have areas in the field that are under or over cultivated or consolidated, and this will effect the crop growth and yield at harvest. The Disc-Roller Contour combats this with its unique contour following system.

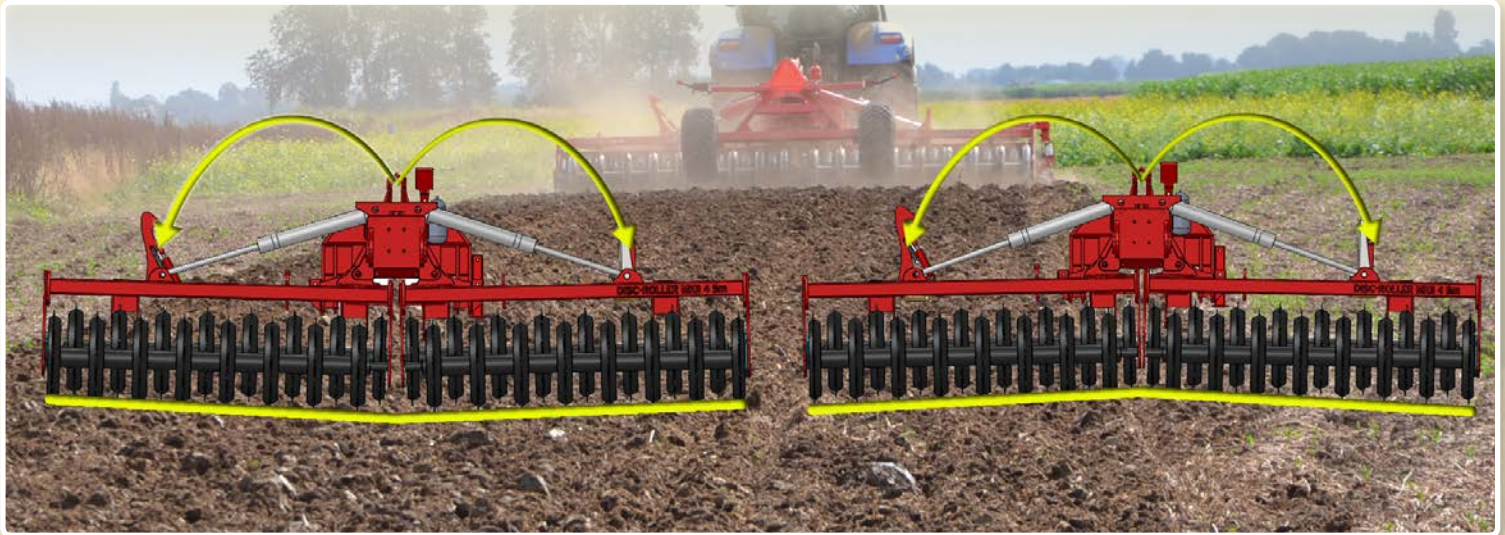

The Disc-Roller Contour's hydraulic folding system is linked to two accumulators and a hydraulic pressure gauge. The gauge allows the operator to even the pressure out across the working width to ensure consistent cultivation on uneven ground. The accumulators act as an oil buffer, when the cultivator travels over uneven ground and the hydraulic rams need to extend or shorten to allow the disc cultivator to follow the contours.

A VERSATILE TOOL

Incorporate stubble and other crop residues to a depth of up to 125mm (5") in minimal tillage cultivations.

Or work ploughed land prior to drilling. With around 1 tonne per metre, you have an efficient consolidating press for secondary cultivations.



UNIQUE DISC TECHNOLOGY

DSD-SYSTEM

The ability to perform many different tasks - from creating stale seedbeds at 2-5 cm to cutting and incorporating crop residues when working in deep in heavy soils - is only possible due to the unique DSD-System (Depth Synchronized Disc System).

The DSD-system is an aggressive depth control system in which the discs are automatically given a more aggressive angle the deeper they penetrate into the soil.



1 When working close to the surface, the DSD system ensures that the disc is perpendicular to the ground (vertical), which means that the discs push the soil horizontally (laterally) and the entire surface of the soil is moved. The vertical angle ensures that the soil is loosened rather than being scooped out, minimising the risk of smearing and jamming.

2 For usage as a deep disc cultivator or for mixing and incorporating crop residues, a more aggressive angle is required. The DSD system automatically increases the aggressiveness by changing the angle of the discs relative to the soil surface.

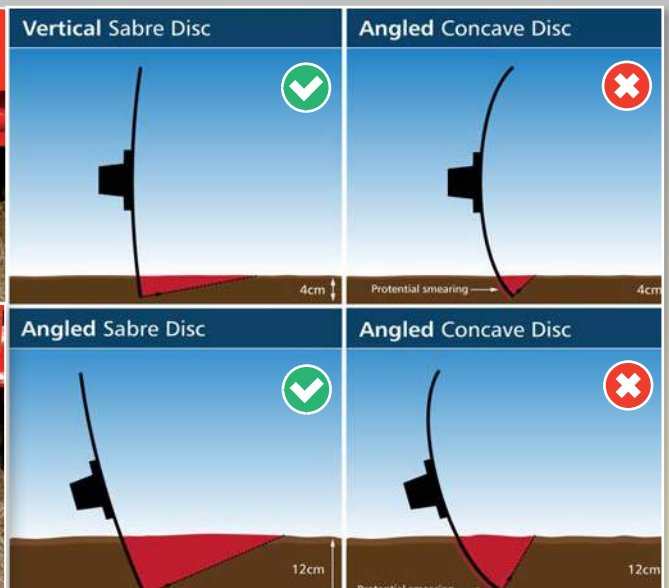

HE-VA 510 MM SABRE DISC

Normal heavily dished discs have too much angle and do not overlap enough to cut all the soil at shallow depths. The Sabre discs' shallow disc angle, with its superb cutting action coupled with the stagger of the two disc rows, provides maximum movement and mixing of soil - even at shallow working depths.

The other advantage of a relatively flat disc is that it does not smear causing a disc pan in wet conditions, whereas the back of a more conventional concave disc smears the soil, as it works, creating a pan and causing problems for crop roots and drainage.



Sabre disc

EFFICIENT LEVELLING AND PRESSING

ROLLER TYPES

Disc-Roller Contour comes with 6 different roller types offering a great degree of flexibility in relation to soil types and to the specific type of job you need the Disc-Roller Contour to do.

V-profile

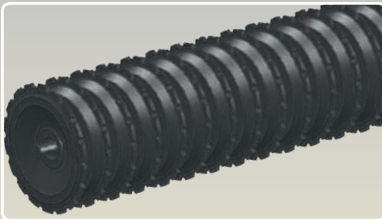

The V-profile roller crushes clods highly efficiently, leaving the soil surface even. Plant, straw and stubble material is pushed down into the surface, thereby promoting decomposition.

U-profile

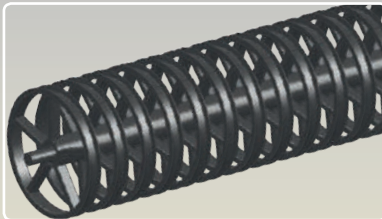

The U-profile roller is designed so that the roller fills with soil during operation, thus achieving good soil-to-soil compaction and giving the soil surface a natural structure without glazing.

Corrugated roller

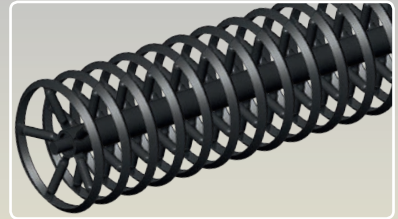

This roller has an optimum compacting effect on light and medium-hard soil types. It leaves a fine soil surface with minimal risk of soil drift.

Square Tube roller

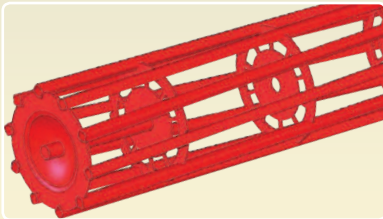

The 550 mm square tube roller provides good depth control and crushes clods in lighter/loose soils.

Twin V-profile roller

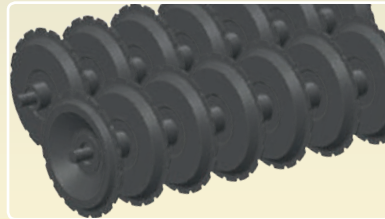

A Twin roller is a good, maintenance-free solution as the rollers clean each other during operation. The V-profile Twin roller leaves the soil surface slightly corrugated, which has a draining effect and contributes to rapid heating and drying.

Twin U-profile roller

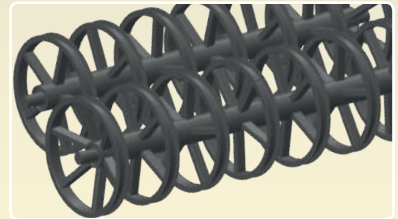

A Twin roller is a good, maintenance-free solution as the rollers clean each other during operation. The Twin U-profile roller provides good soil-to-soil compaction without any glazing.

V-PROFILE ROLLER

Each ring section is castellated ensuring that the roller turns in light soils. The aggressive rib and shoulder profile combined with a 150mm ring spacing will leave an excellent consolidated weatherproof finish. Trailed Disc-Roller Contours can be supplied with both 600mm and the larger 700mm V-Profile ring packer.



V-Profile, 600mm or 700mm diameter

EXTRA EQUIPMENT

Specify Disc-Roller Contour to suit your requirements

SPRING-BOARD

The Disc-Roller Contour is an excellent primary cultivator for cultivating stubble and incorporating crop residues. Add a Spring-Board and you have a superb machine for secondary cultivation as well - a true multipurpose cultivator that can be used on no-till or ploughed land to produce a level, firm seedbed.*



* Spring-Board is only available for trailed models.



LOCKING BARS

The optional locking bars convert the individual springs into a complete "board" for increased levelling effect.

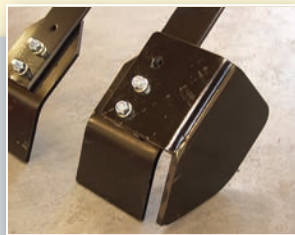

EDGE PLATES

The optional edge plates can be fitted to help keep certain soil types from ridging either side of the press.



SLICING PLATES

On heavier soil types slicing plates can be fitted in lieu of the standard flat plates to slice and fissure the clods better.



FRONT HARROW

When cultivating to create a stale seedbed a Front Harrow with 14mm tines can be fitted to provide shallow soil movement.

TOP-CUTTER

Mounting a Top-Cutter in front of the discs on your Disc-Roller Contour enables you to cut and incorporate residual plants.

The six double-sided knives of the Top-Cutter provides maximum effect and ensures an even and stable soil flow.



OPTIONAL EXTRAS



SOIL MAT

This ensures soil falls in front of the roller to present a level surface to be consolidated. Recommended when fitting a seeder to your Disc Roller.



IN-LINE SYSTEM

When using a drawbar eye, the In-line system makes it possible to trim the parallelism of the harrow in relation to the soil surface directly from the tractor cab.



ELECTRIC DEPTH STOP

This allows a preset depth to be selected. Standard on the larger machines and available on the 2.5 - 6.5m machines.



MULTI-SEEDER MOUNTING KIT

All Disc Rollers can be fitted with a mounting kit suitable for the Multi-Seeder to allow seeding of OSR and cover crops.



FRONT WHEELS

A set of adjustable front mounted pivoting support wheels 500/50 x 17 - 18 PLY for 3,50, 4,00 and 4,50 m models.



LONGFINGER AFTERHARROW

Adjustable spring loaded 12 mm diameter longfinger afterharrow behind the roller. Often fitted when seeding.



HPV CONTROLLER

The HPV-Controller reduces the number of tractor spools needed by controlling up to four double acting functions.



RUBBER-SEALED BALL BEARINGS

Enables the roller to move freely on the soil without damaging the bearings.

ADDITIONAL EXTRAS Hydraulic brakes, air brakes, drawbar extension, trailed kit, 510 x 5 mm aggressive Sabre discs.

DISC-ROLLER CONTOUR SPECIFICATIONS



2.25 - 7.75 m



80 - 240 hp



2.32 - 4.00 m

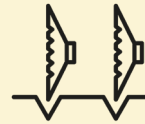

18 - 53 pcs

Model	Working width	Type	Sections	Fold	No. of discs	Power requirement, HP
2.50 m	2.25 m	Mounted & trailed	1	Rigid	18	80+
3.00 m	2.75 m	Mounted & trailed	1	Rigid	22	90 - 100+
3.50 m	3.25 m	Mounted & trailed	1	Rigid	26	100 - 110+
4.00 m	3.75 m	Mounted & trailed	1	Rigid	30	110 - 120+
4.50 m	4.25 m	Mounted & trailed	2	Foldable	34	130 - 140+
5.50 m	5.25 m	Mounted & trailed	2	Foldable	42	160 - 170+
6.50 m	6.25 m	Mounted & trailed	2	Foldable	50	190 - 200+
8.00 m	7.75 m	Trailed	3	Foldable	53	220 - 240+

Your local HE-VA dealer



N. A. Christensensvej 34
DK-7900 Nykøbing Mors

Tel: +45 9772 4288
Fax: +45 9772 2112

Email: info@he-va.com
Web: www.he-va.com

Follow us here

